

EXISTING CONDITIONS/DEMOLITION PLAN
SCALE: 1" = 20'

BENCHMARK DATE
GEODETIC DATUM ACQUIRED VIA THE NCEES KIT,
VERMONT REFERENCING NAD83 (2011) HORIZONTAL

LEGEND

EX PROPERTY CORNER	EX CLEANOUT	EX SANITARY SEWER	EX TELEPHONE UTILITY BOX	EX UG TELEPHONE LINE	EX UG CABLE LINE	EX IRRIGATION SPRINKLER	EX UNKNOWN MANHOLE	EX SIGN	EX TEST BORE	EX MONITORING WELL	EX BOLLARD	EX PARKING METER	EX FLAGPOLE	EX UNSURVEYED LINE	EX SURVEYED RIGHT-OF-WAY LINE	EX DECIDUOUS TREE	EX CREPE MYRTLE	EX SHRUB	EX SHRUB BED	EX CONFESIOUS TREE	EX LANDSCAPING	EX SIDEWALK	EX PARKING PAY STATION	BORE HOLE							
EX APPROX. EASEMENT CORNER	EX DRAINAGE MANHOLE	EX CATCH BASIN	EX STORM SEWER (AS NOTED)	EX GRATE INLET	EX ROUND DRAIN	EX SMALL 1" X 1" DRAIN	EX BACKFLOW PREVENTER	EX AUTO SPRINKLER CONNECTION	EX FIRE DEPARTMENT CONNECTION	EX WATER METER	EX FIRE HYDRANT	EX WATER VALVE	EX WATER MANHOLE	EX WATER LINE	EX ELECTRIC MANHOLE	EX POWER METER	EX UTILITY POLE	EX LIGHT POLE	EX FLOOD LIGHT	EX LAAMP POST	EX DUKE ENERGY UTILITY BOX	EX AERIAL UTILITY	EX UG POWERLINE	EX ELECTRICAL OUTLET	EX TRAFFIC SIGNAL POLE	EX TRAFFIC AREA	EX ELECTRICAL SWITCH	EX HIGH VOLTAGE BOX	EX SANITARY MANHOLE	EX TRASH CAN	EX PROPERTY LINE

DEMO LEGEND

- A 4" WIDE DUKE POWER UTILITY DUCT BANK TO BE PRESERVED/PROTECTED
- B SANITARY SEWER PIPE TO BE REMOVED AS NECESSARY FOR PROPOSED CONSTRUCTION
- C EXISTING STORM SEWER INLET/PIPE TO BE REMOVED
- D EXISTING STORM SEWER INLET/PIPE TO BE PRESERVED/PROTECTED
- E EXISTING COMMUNICATIONS UTILITY TO BE PRESERVED/PROTECTED
- F EXISTING CHAIN LINK FENCE TO BE REMOVED
- G EXISTING CONCRETE/BLOCK/BRICK WALL TO BE REMOVED AS REQUIRED
- H EXISTING CONCRETE/BLOCK/BRICK WALL TO BE PRESERVED/PROTECTED
- I PICNIC TABLES AND CONCRETE PADS TO BE REMOVED
- J REMAINS OF ELEVATOR ASSEMBLY TO BE REMOVED
- K EXISTING BOLLARDS TO BE REMOVED
- L EXISTING WATER LINE TO BE PROTECTED
- M REMOVE AND STORE EXISTING LIGHT AND PARKING METER TO BE REINSTALLED UPON PROJECT COMPLETION
- N REMOVE AND STORE EXISTING SIGNS FOR REINSTALLATION AT COMPLETION OF PROJECT
- O EXISTING SANITARY SEWER LINE TO BE PROTECTED

EXIST. GRAVEL AREA TO BE REMOVED	[Hatched Pattern]
EXIST. PAVEMENT TO BE REMOVED	[Solid Grey]
EXIST. PAVEMENT TO BE MILLED AND OVERLAYED	[Diagonal Hatched]
EXIST. PAVEMENT TO BE REMOVED LEAVING SUB-BASE IN UNDISTURBED	[Cross-hatched]
EXIST. TREE TO BE REMOVED	X

DEMOLITION NOTES

1. THE CONTRACTORS SHALL NOTIFY NORTH CAROLINA 811 (800-632-4949) AT LEAST THREE (3) WORKING DAYS PRIOR TO THE START OF WORK.
2. PRIOR TO STARTING CONSTRUCTION, CONTRACTOR IS TO CONTACT STEVE HARPER, DRIVEWAY INSPECTOR, AT (336) 995-2522 TO ARRANGE FOR A PRE-CONSTRUCTION CONFERENCE.
3. CONTRACTOR SHALL NOTIFY THE CITY OF WASHINGTON-SALEM ENGINEERING FIELD OFFICE (336) 995-2522 AT LEAST TWO (2) WORKING DAYS PRIOR TO ANY WORK TAKING PLACE WITHIN THE RIGHT-OF-WAY TO ARRANGE FOR INSPECTION.
4. NO WORK SHALL BEGIN UNTIL THE PROPER PERMITS HAVE BEEN RELEASED BY ALL RELATED APPROVAL AGENCIES.
5. BOUNDARY AND TOPOGRAPHY INFORMATION SHOWN IS BASED UPON A SURVEY CONDUCTED BY BRADY SURVEYING COMPANY IN MARCH 2016. SURVEY WAS MODIFIED AND REISSUED IN APRIL 2016.
6. OBSTRUCTIONS SHOWN ON THIS DRAWING ARE FOR THE CONVENIENCE OF THE CONTRACTOR ONLY. JOHN DAVENPORT ENGINEERING, INC. DOES NOT WARRANT OR GUARANTEE THE CORRECTNESS OR THE COMPLETENESS OF THE INFORMATION GIVEN. THE CONTRACTOR MUST VERIFY ALL SUCH INFORMATION TO HIS OWN SATISFACTION.
7. CONTRACTOR SHALL NOT PROCEED WITH ANY DEMOLITION WORK UNTIL ALL UTILITY COMPANIES HAVE VERIFIED IN WRITING THAT DISCONNECTIONS HAVE BEEN COMPLETED.
8. CONTRACTOR WILL INSTALL A TEMPORARY CONSTRUCTION FENCE AROUND THE CONSTRUCTION AREA.
9. CONTRACTOR WILL SECURE THE CONSTRUCTION AREA AT THE END OF EACH WORKING DAY AND WILL INSPECT THE SECURITY FENCING TO INSURE ITS INTEGRITY.
10. CONTRACTOR IS RESPONSIBLE TO COMPLY WITH OSHA REGULATIONS AS THEY PERTAIN TO EXISTING ADJACENT BUILDINGS AND PUBLIC SIDEWALKS AND PROVIDING "SAFE" PASSAGE TO THEM.
11. CONTRACTOR WILL INSPECT AND TAKE PICTURES OF ADJACENT BUILDING WALLS AND RETAINING WALLS PRIOR TO THE COMMENCEMENT OF ANY DEMOLITION ON THE SITE. EXISTING WALL CRACKS (IF ANY) WILL BE NOTED.
12. CONTRACTOR WILL CONTINUALLY MONITOR THE WALLS OF THE ADJACENT BUILDINGS AND RETAINING WALLS FOR ANY SIGNS OF STRUCTURAL DISTRESS. IF ANY DISTRESS IS NOTED, CONTRACTOR SHALL STOP WORK IMMEDIATELY AND NOTIFY OWNER, JOHN DAVENPORT ENGINEERING, INC. AND SHELDON BUILDING EXCELLENCE.
13. CONTRACTOR WILL NOT EXPOSE, UNDERMINE, OR IMPACT THE ZONE OF INFLUENCE FOR FOOTINGS AND FOUNDATIONS OF ADJACENT BUILDINGS. CONTRACTOR WILL BE RESPONSIBLE FOR THE COST TO REPAIR ADJACENT BUILDINGS THAT ARE DAMAGED DUE TO HIS OPERATION.
14. CONTRACTOR WILL PROVIDE THE NECESSARY MEANS TO CONTROL DUST AND AIR QUALITY DURING THE DEMOLITION PROCESS.
15. CONTRACTOR WILL SAW CUT EXISTING PAVING TO MINIMIZE DAMAGE TO EXISTING PAVING REMAINING.
16. IN CONJUNCTION WITH THE REMOVAL OF CONCRETE APRONS AND WALKS, THE CONTRACTOR IS RESPONSIBLE TO ADJUST ALL PUBLIC UTILITIES (I.E. MANHOLE FRAMES & COVERS, ELECTRIC HAND BOXES, VALVE COVERS) TO BE FINISHED SIDEWALK GRADES.
17. ANY EXISTING CURB AND GUTTER & CONCRETE SIDEWALK SHALL BE REMOVED TO THE NEAREST JOINT.
18. THE CONTRACTOR IS RESPONSIBLE FOR PERFORMING ALL WORK SHOWN ON THESE DRAWINGS UNLESS OTHERWISE NOTED.
19. THE DEMOLITION INFORMATION SHOWN ON THIS DRAWING IS FOR THE CONVENIENCE OF THE CONTRACTOR ONLY. IT IS THE CONTRACTORS' RESPONSIBILITY TO DETERMINE THE EXACT LIMITS OF DEMOLITION AND REMOVAL OF AFFECTED SITE ITEMS.
20. CONTRACTOR TO VERIFY LOCATION AND ELEVATION OF EXISTING UTILITIES SHOWN HEREON BEFORE STARTING ANY WORK ON THESE PLANS. CONTRACTOR AGREES TO BE FULLY RESPONSIBLE FOR THE COST OF ANY AND ALL DAMAGES WHICH OCCUR AS A RESULT OF A FAILURE TO EXACTLY LOCATE AND PRESERVE ANY AND ALL EXISTING UTILITIES TO REMAIN.
21. THE CONTRACTOR SHALL MAINTAIN POSITIVE DRAINAGE AT ALL TIMES.
22. CONTRACTOR SHALL INSTALL SEDIMENT CONTROLS PRIOR TO BEGINNING ANY WORK AND MAINTAIN SEDIMENT CONTROLS THROUGHOUT THE ENTIRE DURATION OF DEMOLITION AND CONSTRUCTION ACTIVITIES.
23. ALL UTILITY LINES, ELECTRICAL DUCT BANKS, STRUCTURES, ETC. ARE TO BE REMOVED IN THEIR ENTIRETY UNLESS OTHERWISE INDICATED. ALL EXCAVATION SHALL BE BACKFILLED IN ACCORDANCE WITH THE PROJECT SPECIFICATIONS. IN THE EVENT THAT A PORTION OF A UTILITY IS TO BE REMOVED THE CONTRACTOR SHALL TERMINATE & CAP TO THE LIMITS INDICATED IN ACCORDANCE WITH ALL STATE & LOCAL REQUIREMENTS AND THE PROJECT REQUIREMENTS.
24. IT SHALL BE DISTINCTLY UNDERSTOOD THAT FAILURE TO MENTION SPECIFICALLY ANY WORK WHICH WOULD NORMALLY BE REQUIRED TO COMPLETE THIS PROJECT SHALL NOT RELIEVE THE CONTRACTOR OF HIS RESPONSIBILITY TO COMPLETE SUCH WORK.
25. SHOULD THE CONTRACTOR DISCOVER DISCREPANCIES BETWEEN THE PLANS AND FIELD CONDITIONS, THE AE IS TO BE NOTIFIED IMMEDIATELY TO RESOLVE THE SITUATION. SHOULD THE CONTRACTOR MAKE FIELD CORRECTIONS OR ADJUSTMENTS WITHOUT NOTIFYING THE AE, THEN THE CONTRACTOR ASSUMES ALL RESPONSIBILITY FOR THOSE CHANGES.
26. CONTRACTOR SHALL CAP EXISTING UTILITY CONNECTIONS AND PROVIDE THEIR HORIZONTAL AND VERTICAL LOCATIONS TO THE OWNER AND THE ENGINEER.
27. CONTRACTOR SHALL REMOVE ALL CONSTRUCTION DEBRIS FROM THE SITE AND DISPOSE OF IT AT AN APPROVED, PERMITTED DISPOSAL FACILITY. NO RUBBLE IS TO BE LEFT ON SITE.
28. BURNING OF COMBUSTIBLE MATERIALS FROM DEMOLISHED STRUCTURES WILL NOT BE PERMITTED.
29. NO EXPLOSIVES WILL BE USED IN THE SITE DEMOLITION.
30. ALL TREES WITHIN THE LOD ARE TO BE REMOVED UNLESS OTHERWISE NOTED.

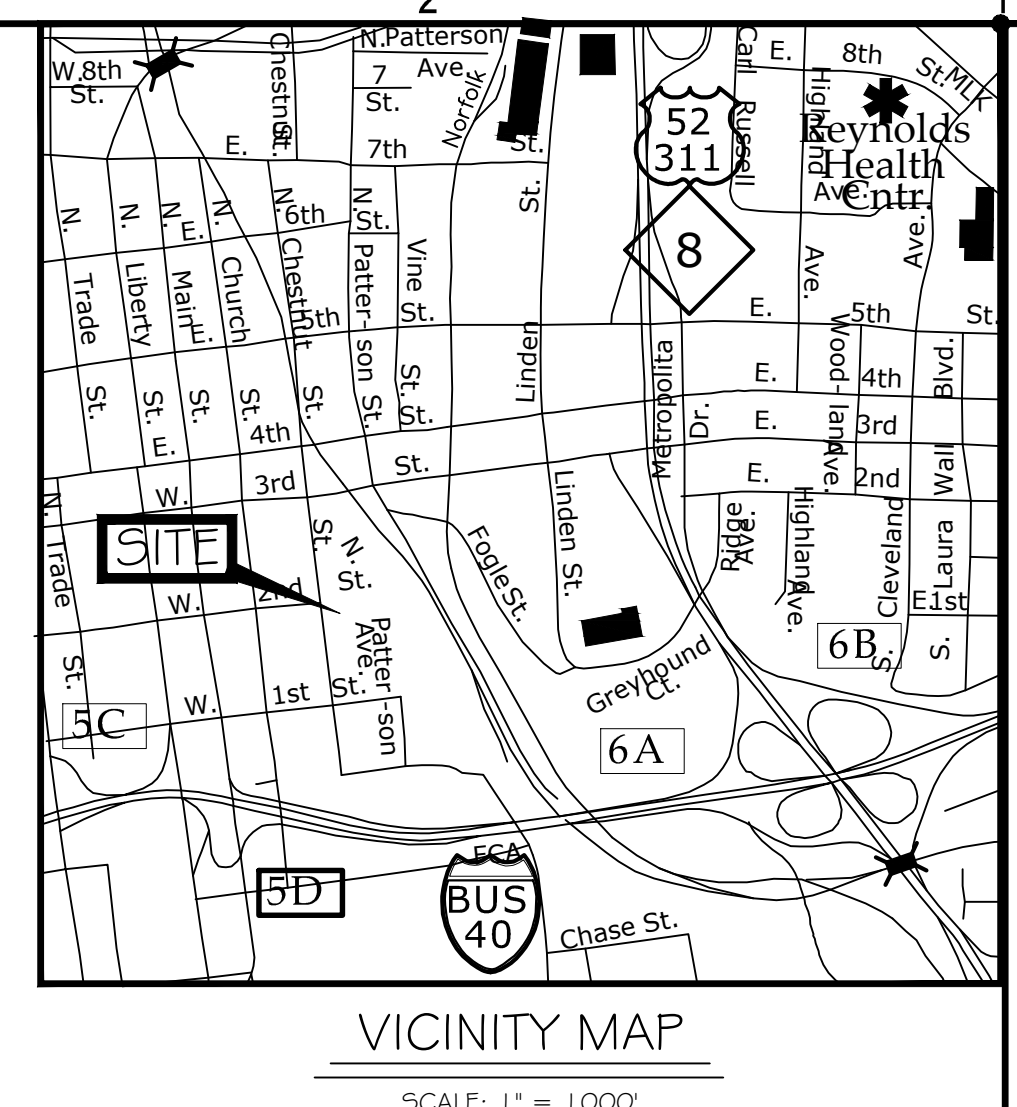

CJMW
ARCHITECTURE
119 Brookstown Ave. Suite 100
Winston-Salem, NC 27101
p. 336.724.1553
www.cjmw.com

OBI
O'BRIEN ATKINS
5001 S. Main Boulevard
Durham, NC 27703
p. 919.441.6900
www.obiatkins.com

SLAM
100 East Pine Street, Suite 300
Chapel Hill, NC 27514
p. 407.992.6300
www.slamcnc.com

DAVENPORT
119 BROOKSTOWN AVE. SUITE 100
WINSTON-SALEM, NC 27101
336.724.1553
www.davenportinc.com
NCEES KIT LICENSE NO. C2827

**CONSTRUCTION DOCUMENTS
CONFORMANCE SET
JANUARY 15, 2021**

Version	Issue Name	Date



Forsyth County Courthouse

Copyright 2019
CJMW Architecture, P.A.

EASEMENT DRAWING

sheet
X.01

date: 09-02-2020
commission: 18-0130
drawn by: RJG design by: RLB

