

PETITION FOR VOLUNTARY ANNEXATION
OF CONTIGUOUS PROPERTY TO
THE CITY OF WINSTON-SALEM

TO THE CITY COUNCIL OF THE CITY OF WINSTON-SALEM, NORTH CAROLINA:

1. We the undersigned owners of real property respectfully request that the area described below be annexed to the City of Winston-Salem.
2. Title of development or area BROOKBERRY FARM - PHASE 8
3. Name/address/phone number of petitioner BROOKBERRY FARM LLC
1540 SILAS CREEK PKWY
WINSTON-SALEM, NC 27102
4. Number of acres 26.118 ACRES
Parcel Identification Number (PIN) (s) 5896-20-7074.000
Tax Block (s) 6576 Tax Lot (s) 574-615 *
5. Developer's projection of number/type of units to be developed by end of:
Year 1 _____
Year 2 _____
Year 3 _____
Build out _____

* INDIVIDUAL SHEETS
FOR EACH LOT
ATTACHED.
6. Developer's estimated value at the end of:
Year 1 _____
Year 3 _____
Build out _____
7. Map Attached: Forsyth County Tax Map X OR Official Survey Map X
8. The area to be annexed is contiguous to the City of Winston-Salem, and the boundaries of such territory are as follows:

NORTH CAROLINA
FORSYTH COUNTY

PETITION FOR VOLUNTARY ANNEXATION
OF CONTIGUOUS PROPERTY TO
THE CITY OF WINSTON-SALEM

* Owners of real property that is wholly exempt from property taxation under the Constitution and laws of North Carolina, railroad companies, public utilities as defined in G.S. 62-3(23), and electric or telephone membership corporations need not sign the petition. (G.S. 160A-58.1(a).

OWNERS/PETITIONERS:

Individual(s):

Signature

Print Name

Address

Signature

Print Name

Address

Corporate Entity:

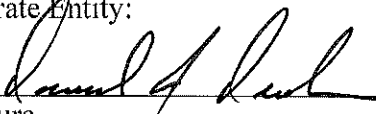
Signature

DANIEL J. DINSBEER
Print Name

BROOKBERRY FARM, LLC
Company/Corporation Name

V.P. OF REAL ESTATE
Title

1540 SILAS CREEK PRWY.
Address

4/27/2023
Date

Respectfully submitted this 28 day of April, 2023.

NORTH CAROLINA)
FORSYTH COUNTY)

PETITION FOR VOLUNTARY ANNEXATION
OF CONTIGUOUS PROPERTY TO THE CITY
OF WINSTON-SALEM

TO THE CITY COUNCIL OF THE CITY OF WINSTON-SALEM, NORTH CAROLINA:

1. We the undersigned owners of real property respectfully request that the area described below be annexed to the City of Winston-Salem.
2. Title of development or area Brookberry Farm- Phase 8 - Lot 574
3. Name/address/phone number of petitioner Desyers, LLC (Rebecca Desai)
583 Brookberry Farm Circle
Winston-Salem, NC 27106
4. Number of acres 0.51 Tax Block (s) 6576 Tax Lot (s) 574
5. Developer's projection of number/type of units to be developed by end of:
Year 1 _____ Year 2 _____
Year 3 _____ Build out _____
6. Developer's estimated value at the end of:
Year 1 _____ Year 2 _____ Year 3 _____ Build out _____
7. Map Attached: Forsyth County Tax Map _____ OR Official Survey Map
8. The area to be annexed is contiguous to the City of Winston-Salem, and the boundaries of such territory are as follows:

Respectfully submitted this 21st day of DECEMBER, 20 22.

Desyers, LLC - [Signature]
Petitioner

(If additional space is needed, please attach a separate sheet. Return form with attachments to the City Clerk, Suite 140, City Hall, Telephone: (336) 727-2224.)

NORTH CAROLINA)
FORSYTH COUNTY)

PETITION FOR VOLUNTARY ANNEXATION
OF CONTIGUOUS PROPERTY TO THE CITY
OF WINSTON-SALEM

TO THE CITY COUNCIL OF THE CITY OF WINSTON-SALEM, NORTH CAROLINA:

1. We the undersigned owners of real property respectfully request that the area described below be annexed to the City of Winston-Salem.
2. Title of development or area BROOKBERRY FARM - PHASE 8
3. Name/address/phone number of petitioner KHURM AND HANDIA KHALID HUSSAEN
577 BROOKBERY FARM CIR.
W-S, NC 27106
4. Number of acres .37 Tax Block (s) 6576 Tax Lot (s) 575
5. Developer's projection of number/type of units to be developed by end of:
Year 1 _____ Year 2 _____
Year 3 _____ Build out _____
6. Developer's estimated value at the end of:
Year 1 _____ Year 2 _____ Year 3 _____ Build out _____
7. Map Attached: Forsyth County Tax Map _____ OR Official Survey Map
8. The area to be annexed is contiguous to the City of Winston-Salem, and the boundaries of such territory are as follows:

Respectfully submitted this 14th day of NOVEMBER, 2022.



Petitioner

(If additional space is needed, please attach a separate sheet. Return form with attachments to the City Clerk, Suite 140, City Hall, Telephone: (336) 727-2224.)

NORTH CAROLINA)
FORSYTH COUNTY)

PETITION FOR VOLUNTARY ANNEXATION
OF CONTIGUOUS PROPERTY TO THE CITY
OF WINSTON-SALEM

TO THE CITY COUNCIL OF THE CITY OF WINSTON-SALEM, NORTH CAROLINA:

1. We the undersigned owners of real property respectfully request that the area described below be annexed to the City of Winston-Salem.
2. Title of development or area BROOKBERRY FARM PHASE 8
3. Name/address/phone number of petitioner BROOKBERRY FARM LLC
571 BROOKBERRY FARM CIR
W-S, NC 27106
4. Number of acres .52 Tax Block (s) 6576 Tax Lot (s) 576
5. Developer's projection of number/type of units to be developed by end of:
Year 1 _____ Year 2 _____
Year 3 _____ Build out _____

577
578
579
580
581
6. Developer's estimated value at the end of:
Year 1 _____ Year 2 _____ Year 3 _____ Build out _____
7. Map Attached: Forsyth County Tax Map _____ OR Official Survey Map
8. The area to be annexed is contiguous to the City of Winston-Salem, and the boundaries of such territory are as follows:

Respectfully submitted this 18TH day of JANUARY, 2023.

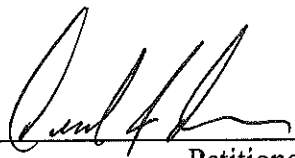

VP of RE
Petitioner

(If additional space is needed, please attach a separate sheet. Return form with attachments to the City Clerk, Suite 140, City Hall, Telephone: (336) 727-2224.)

NORTH CAROLINA)
FORSYTH COUNTY)

PETITION FOR VOLUNTARY ANNEXATION
OF CONTIGUOUS PROPERTY TO THE CITY
OF WINSTON-SALEM

TO THE CITY COUNCIL OF THE CITY OF WINSTON-SALEM, NORTH CAROLINA:

1. We the undersigned owners of real property respectfully request that the area described below be annexed to the City of Winston-Salem.
2. Title of development or area BROOKBERRY FARM - PHASE 8
3. Name/address/phone number of petitioner Kevin and Lindsay Hinshaw
536 BROOKBERRY FARM CIR.
W-S, NC 27106
4. Number of acres _____ Tax Block (s) 6576 Tax Lot (s) 583
5. Developer's projection of number/type of units to be developed by end of:
Year 1 _____ Year 2 _____
Year 3 _____ Build out _____
6. Developer's estimated value at the end of:
Year 1 _____ Year 2 _____ Year 3 _____ Build out _____
7. Map Attached: Forsyth County Tax Map _____ OR Official Survey Map
8. The area to be annexed is contiguous to the City of Winston-Salem, and the boundaries of such territory are as follows:

Respectfully submitted this 18TH day of JANUARY, 2022.

Kevin Michael Hinshaw
Lindsay Hinshaw
Petitioner

(If additional space is needed, please attach a separate sheet. Return form with attachments to the City Clerk, Suite 140, City Hall, Telephone: (336) 727-2224.)

NORTH CAROLINA)
FORSYTH COUNTY)

PETITION FOR VOLUNTARY ANNEXATION
OF CONTIGUOUS PROPERTY TO THE CITY
OF WINSTON-SALEM

TO THE CITY COUNCIL OF THE CITY OF WINSTON-SALEM, NORTH CAROLINA:

1. We the undersigned owners of real property respectfully request that the area described below be annexed to the City of Winston-Salem.
2. Title of development or area BROOKBERRY FARM - PHASE 8
3. Name/address/phone number of petitioner GEORGE & SUSAN LAWSON (TRUSTEES)
524 BROOKBERRY FARM CIR.
W-S, NC 27106
4. Number of acres _____ Tax Block (s) 6576 Tax Lot (s) 584
5. Developer's projection of number/type of units to be developed by end of:
Year 1 _____ Year 2 _____
Year 3 _____ Build out _____
6. Developer's estimated value at the end of:
Year 1 _____ Year 2 _____ Year 3 _____ Build out _____
7. Map Attached: Forsyth County Tax Map _____ OR Official Survey Map
8. The area to be annexed is contiguous to the City of Winston-Salem, and the boundaries of such territory are as follows:

Respectfully submitted this 20TH day of JANUARY, 2023.

Susan Lawson

Susan Lawson
Petitioner

(If additional space is needed, please attach a separate sheet. Return form with attachments to the City Clerk, Suite 140, City Hall, Telephone: (336) 727-2224.)

NORTH CAROLINA)
FORSYTH COUNTY)

PETITION FOR VOLUNTARY ANNEXATION
OF CONTIGUOUS PROPERTY TO THE CITY
OF WINSTON-SALEM

TO THE CITY COUNCIL OF THE CITY OF WINSTON-SALEM, NORTH CAROLINA:

1. We the undersigned owners of real property respectfully request that the area described below be annexed to the City of Winston-Salem.
2. Title of development or area BROOKBERRY FARM - PHASE 8
3. Name/address/phone number of petitioner THE VERITAS GROUP, INC
396 1/2 518 BROOKBERRY FARM CIR
W-S, NC 27106
4. Number of acres .59 Tax Block (s) 6576 Tax Lot (s) 585
.34
5. Developer's projection of number/type of units to be developed by end of: 609
Year 1 _____ Year 2 _____
Year 3 _____ Build out _____
6. Developer's estimated value at the end of:
Year 1 _____ Year 2 _____ Year 3 _____ Build out _____
7. Map Attached: Forsyth County Tax Map _____ OR Official Survey Map
8. The area to be annexed is contiguous to the City of Winston-Salem, and the boundaries of such territory are as follows:

Respectfully submitted this 19TH day of JANUARY, 20 23.

Petitioner

(If additional space is needed, please attach a separate sheet. Return form with attachments to the City Clerk, Suite 140, City Hall, Telephone: (336) 727-2224.)

NORTH CAROLINA)
FORSYTH COUNTY)

PETITION FOR VOLUNTARY ANNEXATION
OF CONTIGUOUS PROPERTY TO THE CITY
OF WINSTON-SALEM

TO THE CITY COUNCIL OF THE CITY OF WINSTON-SALEM, NORTH CAROLINA:

1. We the undersigned owners of real property respectfully request that the area described below be annexed to the City of Winston-Salem.
2. Title of development or area BROOKBERRY FARM - PHASE 8
3. Name/address/phone number of petitioner PEIYA & DELIP PATEL
512 BROOKBERRY FARM CER
W-S, NC 27106
4. Number of acres ~~50~~ 0.54 Tax Block (s) 6576 Tax Lot (s) 586
5. Developer's projection of number/type of units to be developed by end of:
Year 1 _____ Year 2 _____
Year 3 _____ Build out _____
6. Developer's estimated value at the end of:
Year 1 _____ Year 2 _____ Year 3 _____ Build out _____
7. Map Attached: Forsyth County Tax Map _____ OR Official Survey Map
8. The area to be annexed is contiguous to the City of Winston-Salem, and the boundaries of such territory are as follows:

Respectfully submitted this January day of 25, 2023.

Delip Patel
Petitioner

(If additional space is needed, please attach a separate sheet. Return form with attachments to the City Clerk, Suite 140, City Hall, Telephone: (336) 727-2224.)

NORTH CAROLINA
FORSYTH COUNTY

PETITION FOR VOLUNTARY ANNEXATION
OF CONTIGUOUS PROPERTY TO
THE CITY OF WINSTON-SALEM

TO THE CITY COUNCIL OF THE CITY OF WINSTON-SALEM, NORTH CAROLINA:

1. We the undersigned owners of real property respectfully request that the area described below be annexed to the City of Winston-Salem.

2. Title of development or area BROOKBERRY FARM - PHASE 8

3. Name/address/phone number of petitioner NEVIN HOME BUILDERS, LLC
1223 MAPLE CHASE LANE
487 & 439 BROOKBERRY FARM CIR.
WI-5, NC 27106

4. Number of acres .40 / .54 / .43 1223 - 5896 - 20 - 3531
Parcel Identification Number (PIN) (s) 487 - 5895 - 39 - 3940
439 5895 - 29 - 5869
Tax Block (s) 6576 Tax Lot (s) 487 - 595 - 613

5. Developer's projection of number/type of units to be developed by end of:

Year 1 _____
Year 2 _____
Year 3 _____
Build out _____

6. Developer's estimated value at the end of:

Year 1 _____
Year 3 _____
Build out _____

7. Map Attached: Forsyth County Tax Map _____ OR Official Survey Map

8. The area to be annexed is contiguous to the City of Winston-Salem, and the boundaries of such territory are as follows:

NORTH CAROLINA
FORSYTH COUNTY

PETITION FOR VOLUNTARY ANNEXATION
OF CONTIGUOUS PROPERTY TO
THE CITY OF WINSTON-SALEM

* Owners of real property that is wholly exempt from property taxation under the Constitution and laws of North Carolina, railroad companies, public utilities as defined in G.S. 62-3(23), and electric or telephone membership corporations need not sign the petition. (G.S. 160A-58.1(a)).

OWNERS/PETITIONERS:

Individual(s):

Signature

Print Name

Address

Signature

Print Name

Address

Corporate Entity:



Signature

MARC NEVIN

Print Name

NEVIN HOME BUILDERS, LLC

Company/Corporation Name

PRESIDENT

Title

2193 SUMMERLYN PARK DR.

Address

4/7/23

Date

KENNESVILLE, NC
27284

Respectfully submitted this 7th day of APRIL, 20 23.

NORTH CAROLINA)
FORSYTH COUNTY)

PETITION FOR VOLUNTARY ANNEXATION
OF CONTIGUOUS PROPERTY TO THE CITY
OF WINSTON-SALEM

TO THE CITY COUNCIL OF THE CITY OF WINSTON-SALEM, NORTH CAROLINA:

1. We the undersigned owners of real property respectfully request that the area described below be annexed to the City of Winston-Salem.
2. Title of development or area BROOKBERRY FARM - PHASE 8
3. Name/address/phone number of petitioner BROOKBERRY FARM, LLC
481 + 475 BROOKBERRY FARM CIR
4. Number of acres .48 / .34 Tax Block (s) 6576 Tax Lot (s) 588 + 589
5. Developer's projection of number/type of units to be developed by end of:
Year 1 _____ Year 2 _____
Year 3 _____ Build out _____
6. Developer's estimated value at the end of:
Year 1 _____ Year 2 _____ Year 3 _____ Build out _____
7. Map Attached: Forsyth County Tax Map _____ OR Official Survey Map
8. The area to be annexed is contiguous to the City of Winston-Salem, and the boundaries of such territory are as follows:

Respectfully submitted this 17TH day of JANUARY, 20 23.

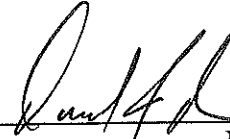
 VP of RE
Petitioner

(If additional space is needed, please attach a separate sheet. Return form with attachments to the City Clerk, Suite 140, City Hall, Telephone: (336) 727-2224.)

PETITION FOR VOLUNTARY ANNEXATION
OF CONTIGUOUS PROPERTY TO
THE CITY OF WINSTON-SALEM

TO THE CITY COUNCIL OF THE CITY OF WINSTON-SALEM, NORTH CAROLINA:

1. We the undersigned owners of real property respectfully request that the area described below be annexed to the City of Winston-Salem.

2. Title of development or area BROOKBERRY FARM - PHASE 8

3. Name/address/phone number of petitioner MITCHCO, INC
421, 463 & 469 BROOKBERRY FARM CIR.
W-5, NC 27106

4. Number of acres .35 / .39 / .33 590 - 5895-39-0755
Parcel Identification Number (PIN) (s) 591 - 5895-29-9744
598 - 5896-20-3100
Tax Block (s) 590, 591, & 598 Tax Lot (s) 6576
LOT BLOCK

5. Developer's projection of number/type of units to be developed by end of:

Year 1 _____
Year 2 _____
Year 3 _____
Build out _____

6. Developer's estimated value at the end of:

Year 1 _____
Year 3 _____
Build out _____

7. Map Attached: Forsyth County Tax Map _____ OR Official Survey Map ✓

8. The area to be annexed is contiguous to the City of Winston-Salem, and the boundaries of such territory are as follows:

NORTH CAROLINA
FORSYTH COUNTY

PETITION FOR VOLUNTARY ANNEXATION
OF CONTIGUOUS PROPERTY TO
THE CITY OF WINSTON-SALEM

* Owners of real property that is wholly exempt from property taxation under the Constitution and laws of North Carolina, railroad companies, public utilities as defined in G.S. 62-3(23), and electric or telephone membership corporations need not sign the petition. (G.S. 160A-58.1(a)).

OWNERS/PETITIONERS:

Individual(s):

Signature

Print Name

Address

Signature

Print Name

Address

Corporate Entity:

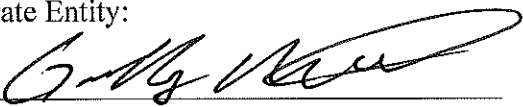

Signature

Geoffrey Mitchell

Print Name

MITCHCO, INC

Company/Corporation Name

PRESIDENT

Title

1111 S. MARSHALL ST

Address

4-7-23

Date

Respectfully submitted this 9TH day of APRIL, 2023.

NORTH CAROLINA)
FORSYTH COUNTY)

PETITION FOR VOLUNTARY ANNEXATION
OF CONTIGUOUS PROPERTY TO THE CITY
OF WINSTON-SALEM

TO THE CITY COUNCIL OF THE CITY OF WINSTON-SALEM, NORTH CAROLINA:

1. We the undersigned owners of real property respectfully request that the area described below be annexed to the City of Winston-Salem.
2. Title of development or area BROOKBERRY FARM - PHASE 8
3. Name/address/phone number of petitioner BROOKBERRY FARM, LLC
457 BROOKBERRY FARM CIR.
W-S, NC 27106
4. Number of acres _____ Tax Block (s) 6576 Tax Lot (s) 592
5. Developer's projection of number/type of units to be developed by end of:
Year 1 _____ Year 2 _____
Year 3 _____ Build out _____
6. Developer's estimated value at the end of:
Year 1 _____ Year 2 _____ Year 3 _____ Build out _____
7. Map Attached: Forsyth County Tax Map _____ OR Official Survey Map
8. The area to be annexed is contiguous to the City of Winston-Salem, and the boundaries of such territory are as follows:

Respectfully submitted this 20TH day of JANUARY, 20 23.



Petitioner VP of RE

(If additional space is needed, please attach a separate sheet. Return form with attachments to the City Clerk, Suite 140, City Hall, Telephone: (336) 727-2224.)

NORTH CAROLINA)
FORSYTH COUNTY)

PETITION FOR VOLUNTARY ANNEXATION
OF CONTIGUOUS PROPERTY TO THE CITY
OF WINSTON-SALEM

TO THE CITY COUNCIL OF THE CITY OF WINSTON-SALEM, NORTH CAROLINA:

1. We the undersigned owners of real property respectfully request that the area described below be annexed to the City of Winston-Salem.
2. Title of development or area BROOKBERRY FARM - PHASE 8
3. Name/address/phone number of petitioner WISHON & CARTER BUILDERS, INC.
451 4
BROOKBERRY FARM CIR
W-S, NC 27106
4. Number of acres .43 / .34 Tax Block (s) 6576 Tax Lot (s) 593
610
5. Developer's projection of number/type of units to be developed by end of:
Year 1 _____ Year 2 _____
Year 3 _____ Build out _____
6. Developer's estimated value at the end of:
Year 1 _____ Year 2 _____ Year 3 _____ Build out _____
7. Map Attached: Forsyth County Tax Map _____ OR Official Survey Map
8. The area to be annexed is contiguous to the City of Winston-Salem, and the boundaries of such territory are as follows:

Respectfully submitted this 24TH day of JANUARY, 2023.

R. Edward Carter - President
Petitioner

(If additional space is needed, please attach a separate sheet. Return form with attachments to the City Clerk, Suite 140, City Hall, Telephone: (336) 727-2224.)

NORTH CAROLINA)
FORSYTH COUNTY)

PETITION FOR VOLUNTARY ANNEXATION
OF CONTIGUOUS PROPERTY TO THE CITY
OF WINSTON-SALEM

TO THE CITY COUNCIL OF THE CITY OF WINSTON-SALEM, NORTH CAROLINA:

1. We the undersigned owners of real property respectfully request that the area described below be annexed to the City of Winston-Salem.
2. Title of development or area BROOKBERRY FARM - PHASE 8
3. Name/address/phone number of petitioner BENCHMARK HOMES INC.
445 BROOKBERRY FARM CIR
W-S, NC 27106
4. Number of acres .43 Tax Block (s) 6576 Tax Lot (s) 594
5. Developer's projection of number/type of units to be developed by end of:
Year 1 _____ Year 2 _____
Year 3 _____ Build out _____
6. Developer's estimated value at the end of:
Year 1 _____ Year 2 _____ Year 3 _____ Build out _____
7. Map Attached: Forsyth County Tax Map _____ OR Official Survey Map
8. The area to be annexed is contiguous to the City of Winston-Salem, and the boundaries of such territory are as follows:

Respectfully submitted this 22ND day of JANUARY, 20 23.

Steve M. Felt
Petitioner

(If additional space is needed, please attach a separate sheet. Return form with attachments to the City Clerk, Suite 140, City Hall, Telephone: (336) 727-2224.)

ORIGINAL vs/ Lot 587

NORTH CAROLINA)
FORSYTH COUNTY)

PETITION FOR VOLUNTARY ANNEXATION
OF CONTIGUOUS PROPERTY TO THE CITY
OF WINSTON-SALEM

TO THE CITY COUNCIL OF THE CITY OF WINSTON-SALEM, NORTH CAROLINA:

1. We the undersigned owners of real property respectfully request that the area described below be annexed to the City of Winston-Salem.
2. Title of development or area BROOKBERRY FARM - PHASE B
3. Name/address/phone number of petitioner NEVIN HOME BUILDERS, INC.
1223 MAPLE CHASE LANE W-S, NC 27106
487 BROOKBERRY FARM CIR. W-S, NC 27106
439 BROOKBERRY FARM CIR. W-S NC 27106
4. Number of acres _____ Tax Block (s) 6576 Tax Lot (s) 587 & 613
5. Developer's projection of number/type of units to be developed by end of: 595
Year 1 _____ Year 2 _____
Year 3 _____ Build out _____
6. Developer's estimated value at the end of:
Year 1 _____ Year 2 _____ Year 3 _____ Build out _____
7. Map Attached: Forsyth County Tax Map _____ OR Official Survey Map
8. The area to be annexed is contiguous to the City of Winston-Salem, and the boundaries of such territory are as follows:

Respectfully submitted this 9TH day of NOVEMBER, 2022.



Petitioner

(If additional space is needed, please attach a separate sheet. Return form with attachments to the City Clerk, Suite 140, City Hall, Telephone: (336) 727-2224.)

NORTH CAROLINA)
FORSYTH COUNTY)

PETITION FOR VOLUNTARY ANNEXATION
OF CONTIGUOUS PROPERTY TO THE CITY
OF WINSTON-SALEM

TO THE CITY COUNCIL OF THE CITY OF WINSTON-SALEM, NORTH CAROLINA:

1. We the undersigned owners of real property respectfully request that the area described below be annexed to the City of Winston-Salem.
2. Title of development or area BROOKBERRY FARM - PHASE 8
3. Name/address/phone number of petitioner HOMES BY JONATHAN LEE INC
433 BROOKBERRY FARM CTR.
W-S, NC 27106
4. Number of acres .43 Tax Block (s) 6576 Tax Lot (s) 596
5. Developer's projection of number/type of units to be developed by end of:
Year 1 _____ Year 2 _____
Year 3 _____ Build out _____
6. Developer's estimated value at the end of:
Year 1 _____ Year 2 _____ Year 3 _____ Build out _____
7. Map Attached: Forsyth County Tax Map _____ OR Official Survey Map
8. The area to be annexed is contiguous to the City of Winston-Salem, and the boundaries of such territory are as follows:

Respectfully submitted this 20TH day of JANUARY, 2023.

Homes by Jonathan M. Lee, Inc.
by Jonathan M. Lee, President
Petitioner

(If additional space is needed, please attach a separate sheet. Return form with attachments to the City Clerk, Suite 140, City Hall, Telephone: (336) 727-2224.)

NORTH CAROLINA)
FORSYTH COUNTY)

PETITION FOR VOLUNTARY ANNEXATION
OF CONTIGUOUS PROPERTY TO THE CITY
OF WINSTON-SALEM

TO THE CITY COUNCIL OF THE CITY OF WINSTON-SALEM, NORTH CAROLINA:

1. We the undersigned owners of real property respectfully request that the area described below be annexed to the City of Winston-Salem.
2. Title of development or area BROOKBERRY FARM, LLC
3. Name/address/phone number of petitioner BROOKBERRY FARM, LLC
427 BROOKBERRY FARM, LLC
W-S, NC 27100
4. Number of acres _____ Tax Block (s) 6576 Tax Lot (s) 597
5. Developer's projection of number/type of units to be developed by end of:
Year 1 _____ Year 2 _____
Year 3 _____ Build out _____
6. Developer's estimated value at the end of:
Year 1 _____ Year 2 _____ Year 3 _____ Build out _____
7. Map Attached: Forsyth County Tax Map _____ OR Official Survey Map
8. The area to be annexed is contiguous to the City of Winston-Salem, and the boundaries of such territory are as follows:

Respectfully submitted this 20TH day of JANUARY, 20 23.



VP OF RE
Petitioner

(If additional space is needed, please attach a separate sheet. Return form with attachments to the City Clerk, Suite 140, City Hall, Telephone: (336) 727-2224.)

ORIGINAL w/ 590

NORTH CAROLINA
FORSYTH COUNTY

PETITION FOR VOLUNTARY ANNEXATION
OF CONTIGUOUS PROPERTY TO
THE CITY OF WINSTON-SALEM

TO THE CITY COUNCIL OF THE CITY OF WINSTON-SALEM, NORTH CAROLINA:

1. We the undersigned owners of real property respectfully request that the area described below be annexed to the City of Winston-Salem.

2. Title of development or area BROOKBERRY FARM - PHASE 8

3. Name/address/phone number of petitioner MITCHCO, INC
421, 463 & 469 BROOKBERRY FARM CIR.
W-S, NC 27106

4. Number of acres .35 / .39 / .33 590 - 5895-39-0755
591 - 5895-29-9744
Parcel Identification Number (PIN) (s) 598 - 5896-20-3100
Tax Block (s) 590, 591, & 598 Tax Lot (s) 6576
LOT BLOCK

5. Developer's projection of number/type of units to be developed by end of:

Year 1 _____
Year 2 _____
Year 3 _____
Build out _____

6. Developer's estimated value at the end of:

Year 1 _____
Year 3 _____
Build out _____

7. Map Attached: Forsyth County Tax Map _____ OR Official Survey Map

8. The area to be annexed is contiguous to the City of Winston-Salem, and the boundaries of such territory are as follows:

NORTH CAROLINA)
FORSYTH COUNTY)

PETITION FOR VOLUNTARY ANNEXATION
OF CONTIGUOUS PROPERTY TO THE CITY
OF WINSTON-SALEM

TO THE CITY COUNCIL OF THE CITY OF WINSTON-SALEM, NORTH CAROLINA:

1. We the undersigned owners of real property respectfully request that the area described below be annexed to the City of Winston-Salem.
2. Title of development or area BROOKBERRY FARM - PHASE 8
3. Name/address/phone number of petitioner DREAM BUILDERS WS CONST, LLC
415 BROOKBERRY FARM CER.
W-S, NC 27106
4. Number of acres .25 Tax Block (s) 6576 Tax Lot (s) 599
5. Developer's projection of number/type of units to be developed by end of:
Year 1 _____ Year 2 _____
Year 3 _____ Build out _____
6. Developer's estimated value at the end of:
Year 1 _____ Year 2 _____ Year 3 _____ Build out _____
7. Map Attached: Forsyth County Tax Map _____ OR Official Survey Map
8. The area to be annexed is contiguous to the City of Winston-Salem, and the boundaries of such territory are as follows:

Respectfully submitted this 22ND day of JANUARY, 20 23.

, MANAGER
Petitioner

(If additional space is needed, please attach a separate sheet. Return form with attachments to the City Clerk, Suite 140, City Hall, Telephone: (336) 727-2224.)

NORTH CAROLINA)
FORSYTH COUNTY)

PETITION FOR VOLUNTARY ANNEXATION
OF CONTIGUOUS PROPERTY TO THE CITY
OF WINSTON-SALEM

TO THE CITY COUNCIL OF THE CITY OF WINSTON-SALEM, NORTH CAROLINA:

1. We the undersigned owners of real property respectfully request that the area described below be annexed to the City of Winston-Salem.
2. Title of development or area BROOKBERRY FARM, LLC
3. Name/address/phone number of petitioner RICHARD SMITH AND
LUCIANA GIAMBARBERI
499 BROOKBERRY FARM CIR
W-S, NC 27106
4. Number of acres .25 Tax Block (s) 6576 Tax Lot (s) 600
5. Developer's projection of number/type of units to be developed by end of:
Year 1 _____ Year 2 _____
Year 3 _____ Build out _____
6. Developer's estimated value at the end of:
Year 1 _____ Year 2 _____ Year 3 _____ Build out _____
7. Map Attached: Forsyth County Tax Map _____ OR Official Survey Map
8. The area to be annexed is contiguous to the City of Winston-Salem, and the boundaries of such territory are as follows:

Respectfully submitted this 24th day of JANUARY, 2023.

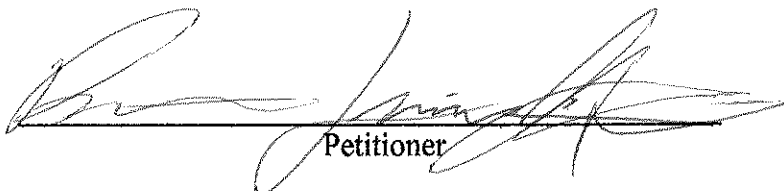
Petitioner

(If additional space is needed, please attach a separate sheet. Return form with attachments to the City Clerk, Suite 140, City Hall, Telephone: (336) 727-2224.)

NORTH CAROLINA)
FORSYTH COUNTY)

PETITION FOR VOLUNTARY ANNEXATION
OF CONTIGUOUS PROPERTY TO THE CITY
OF WINSTON-SALEM

TO THE CITY COUNCIL OF THE CITY OF WINSTON-SALEM, NORTH CAROLINA:

1. We the undersigned owners of real property respectfully request that the area described below be annexed to the City of Winston-Salem.
2. Title of development or area BROOKBERRY FARM - PHASE 8
3. Name/address/phone number of petitioner PAO CHU CAROLINE CHUNG
403 BROOKBERRY FARM CDB.
WI-S, N.C 27104
4. Number of acres - 23 Tax Block (s) 6574 Tax Lot (s) 601
5. Developer's projection of number/type of units to be developed by end of:
Year 1 _____ Year 2 _____
Year 3 _____ Build out _____
6. Developer's estimated value at the end of:
Year 1 _____ Year 2 _____ Year 3 _____ Build out _____
7. Map Attached: Forsyth County Tax Map _____ OR Official Survey Map
8. The area to be annexed is contiguous to the City of Winston-Salem, and the boundaries of such territory are as follows:

Respectfully submitted this 22ND day of DECEMBER, 2022.

Pao Chu Caroline Chung
Petitioner

(If additional space is needed, please attach a separate sheet. Return form with attachments to the City Clerk, Suite 140, City Hall, Telephone: (336) 727-2224.)

NORTH CAROLINA
FORSYTH COUNTY

PETITION FOR VOLUNTARY ANNEXATION
OF CONTIGUOUS PROPERTY TO
THE CITY OF WINSTON-SALEM

TO THE CITY COUNCIL OF THE CITY OF WINSTON-SALEM, NORTH CAROLINA:

1. We the undersigned owners of real property respectfully request that the area described below be annexed to the City of Winston-Salem.

2. Title of development or area BROOKBERRY FARM PHASE 8

3. Name/address/phone number of petitioner TSENHOR HOMES, LLC
391 & 397 BROOKBERRY FARM CIR.
W-NC 27100

4. Number of acres .25 / .28 391 - 5896.10.9135
Parcel Identification Number (PIN) (s) 392 - 5896.20.0102
Tax Block (s) 6570 Tax Lot (s) 602 & 603

5. Developer's projection of number/type of units to be developed by end of:

Year 1 _____
Year 2 _____
Year 3 _____
Build out _____

6. Developer's estimated value at the end of:

Year 1 _____
Year 3 _____
Build out _____

7. Map Attached: Forsyth County Tax Map _____ OR Official Survey Map ✓

8. The area to be annexed is contiguous to the City of Winston-Salem, and the boundaries of such territory are as follows:

NORTH CAROLINA
FORSYTH COUNTY

PETITION FOR VOLUNTARY ANNEXATION
OF CONTIGUOUS PROPERTY TO
THE CITY OF WINSTON-SALEM

* Owners of real property that is wholly exempt from property taxation under the Constitution and laws of North Carolina, railroad companies, public utilities as defined in G.S. 62-3(23), and electric or telephone membership corporations need not sign the petition. (G.S. 160A-58.1(a)).

OWNERS/PETITIONERS:

Individual(s):

Signature

Print Name

Address

Signature

Print Name

Address

Corporate Entity:



Signature

Bill WALTER

Print Name

ISENBUR HOMES, LLC

Company/Corporation Name

MANAGER

Title

3411 HEALY DR STE A

Address WINSTON SALEM NC 27103

4-11-23

Date

Respectfully submitted this _____ day of _____, 20_____.

NORTH CAROLINA)
FORSYTH COUNTY)

PETITION FOR VOLUNTARY ANNEXATION
OF CONTIGUOUS PROPERTY TO THE CITY
OF WINSTON-SALEM

TO THE CITY COUNCIL OF THE CITY OF WINSTON-SALEM, NORTH CAROLINA:

1. We the undersigned owners of real property respectfully request that the area described below be annexed to the City of Winston-Salem.
2. Title of development or area BROOKBERRY FARM - PHASE 8
3. Name/address/phone number of petitioner BROOKBERRY FARM, LLC
378, 379, 384 & 385 BROOKBERRY FARM CIR
W-S, NC 27106
.31/.40/.28/.28
4. Number of acres 9 Tax Block (s) 6576 Tax Lot (s) 604, 605
606, 607
5. Developer's projection of number/type of units to be developed by end of:
Year 1 _____ Year 2 _____
Year 3 _____ Build out _____
6. Developer's estimated value at the end of:
Year 1 _____ Year 2 _____ Year 3 _____ Build out _____
7. Map Attached: Forsyth County Tax Map _____ OR Official Survey Map
8. The area to be annexed is contiguous to the City of Winston-Salem, and the boundaries of such territory are as follows:

Respectfully submitted this 20TH day of JANUARY, 2023.

 VP of RE
Petitioner

(If additional space is needed, please attach a separate sheet. Return form with attachments to the City Clerk, Suite 140, City Hall, Telephone: (336) 727-2224.)

NORTH CAROLINA)
FORSYTH COUNTY)

PETITION FOR VOLUNTARY ANNEXATION
OF CONTIGUOUS PROPERTY TO THE CITY
OF WINSTON-SALEM

TO THE CITY COUNCIL OF THE CITY OF WINSTON-SALEM, NORTH CAROLINA:

1. We the undersigned owners of real property respectfully request that the area described below be annexed to the City of Winston-Salem.
2. Title of development or area BROOKBERRY FARM - PHASE 8
3. Name/address/phone number of petitioner J READER CONST. LLC
390 BROOKBERRY FARM CIR
W-S, NC 27106
4. Number of acres .31 Tax Block (s) 6576 Tax Lot (s) 608
5. Developer's projection of number/type of units to be developed by end of:
Year 1 _____ Year 2 _____
Year 3 _____ Build out _____
6. Developer's estimated value at the end of:
Year 1 _____ Year 2 _____ Year 3 _____ Build out _____
7. Map Attached: Forsyth County Tax Map _____ OR Official Survey Map
8. The area to be annexed is contiguous to the City of Winston-Salem, and the boundaries of such territory are as follows:

Respectfully submitted this 20TH day of JANUARY, 2023.

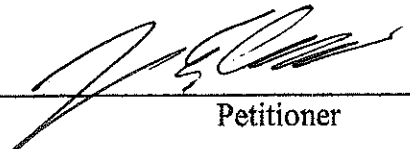

Petitioner

(If additional space is needed, please attach a separate sheet. Return form with attachments to the City Clerk, Suite 140, City Hall, Telephone: (336) 727-2224.)

NORTH CAROLINA)
FORSYTH COUNTY)

PETITION FOR VOLUNTARY ANNEXATION
OF CONTIGUOUS PROPERTY TO THE CITY
OF WINSTON-SALEM

TO THE CITY COUNCIL OF THE CITY OF WINSTON-SALEM, NORTH CAROLINA:

- 1. We the undersigned owners of real property respectfully request that the area described below be annexed to the City of Winston-Salem.
- 2. Title of development or area BROOKBERRY FARM - PHASE 8
- 3. Name/address/phone number of petitioner VERITAS HOMES
396 1 518 BROOKBERRY FARM CTR
W-S, NC 27106
- 4. Number of acres .59 Tax Block (s) 6576 Tax Lot (s) 585
.34
- 5. Developer's projection of number/type of units to be developed by end of: 609
Year 1 _____ Year 2 _____
Year 3 _____ Build out _____
- 6. Developer's estimated value at the end of:
Year 1 _____ Year 2 _____ Year 3 _____ Build out _____
- 7. Map Attached: Forsyth County Tax Map _____ OR Official Survey Map
- 8. The area to be annexed is contiguous to the City of Winston-Salem, and the boundaries of such territory are as follows:

Respectfully submitted this 19TH day of JANUARY, 2023.

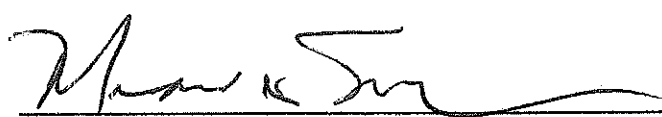
Petitioner

(If additional space is needed, please attach a separate sheet. Return form with attachments to the City Clerk, Suite 140, City Hall, Telephone: (336) 727-2224.)

ORIGINAL w/ Lot 593

NORTH CAROLINA)
FORSYTH COUNTY)

PETITION FOR VOLUNTARY ANNEXATION
OF CONTIGUOUS PROPERTY TO THE CITY
OF WINSTON-SALEM

TO THE CITY COUNCIL OF THE CITY OF WINSTON-SALEM, NORTH CAROLINA:

1. We the undersigned owners of real property respectfully request that the area described below be annexed to the City of Winston-Salem.
2. Title of development or area BROOKBERRY FARM - PHASE 8
3. Name/address/phone number of petitioner WISHON J CARTER
451 S BROOKBERRY FARM CIR
W-S, NC 27106
4. Number of acres .43 / .34 Tax Block (s) 6576 Tax Lot (s) 593
610
5. Developer's projection of number/type of units to be developed by end of:
Year 1 _____ Year 2 _____
Year 3 _____ Build out _____
6. Developer's estimated value at the end of:
Year 1 _____ Year 2 _____ Year 3 _____ Build out _____
7. Map Attached: Forsyth County Tax Map _____ OR Official Survey Map
8. The area to be annexed is contiguous to the City of Winston-Salem, and the boundaries of such territory are as follows:

Respectfully submitted this _____ day of _____, 20_____.

R. Edward Carter - President
Petitioner

(If additional space is needed, please attach a separate sheet. Return form with attachments to the City Clerk, Suite 140, City Hall, Telephone: (336) 727-2224.)

NORTH CAROLINA)
FORSYTH COUNTY)

PETITION FOR VOLUNTARY ANNEXATION
OF CONTIGUOUS PROPERTY TO THE CITY
OF WINSTON-SALEM

TO THE CITY COUNCIL OF THE CITY OF WINSTON-SALEM, NORTH CAROLINA:

1. We the undersigned owners of real property respectfully request that the area described below be annexed to the City of Winston-Salem.
2. Title of development or area BROOKBERRY FARM - PHASE
3. Name/address/phone number of petitioner TRACY & MARGARET WEAVER
414 BROOKBERRY FARM CIR
W-S, NC 27106
4. Number of acres .40 Tax Block (s) 6570 Tax Lot (s) 611
5. Developer's projection of number/type of units to be developed by end of:
Year 1 _____ Year 2 _____
Year 3 _____ Build out _____
6. Developer's estimated value at the end of:
Year 1 _____ Year 2 _____ Year 3 _____ Build out _____
7. Map Attached: Forsyth County Tax Map _____ OR Official Survey Map
8. The area to be annexed is contiguous to the City of Winston-Salem, and the boundaries of such territory are as follows:

Respectfully submitted this 24th day of January, 20 23.

Margaret Weaver
Petitioner

(If additional space is needed, please attach a separate sheet. Return form with attachments to the City Clerk, Suite 140, City Hall, Telephone: (336) 727-2224.)

NORTH CAROLINA
FORSYTH COUNTY

PETITION FOR VOLUNTARY ANNEXATION
OF CONTIGUOUS PROPERTY TO
THE CITY OF WINSTON-SALEM

TO THE CITY COUNCIL OF THE CITY OF WINSTON-SALEM, NORTH CAROLINA:

1. We the undersigned owners of real property respectfully request that the area described below be annexed to the City of Winston-Salem.

2. Title of development or area BROOKBERRY FARM - PHASE 8

3. Name/address/phone number of petitioner GREGORY & JAMIE LAPP
1229 MAPLE CHASE LANE
W-S, NC 27106

4. Number of acres .40

Parcel Identification Number (PIN) (s) 5896-20-3228

Tax Block (s) 6576 Tax Lot (s) 612

5. Developer's projection of number/type of units to be developed by end of:

Year 1 _____

Year 2 _____

Year 3 _____

Build out _____

6. Developer's estimated value at the end of:

Year 1 _____

Year 3 _____

Build out _____

7. Map Attached: Forsyth County Tax Map _____ OR Official Survey Map

8. The area to be annexed is contiguous to the City of Winston-Salem, and the boundaries of such territory are as follows:

NORTH CAROLINA
FORSYTH COUNTY

PETITION FOR VOLUNTARY ANNEXATION
OF CONTIGUOUS PROPERTY TO
THE CITY OF WINSTON-SALEM

* Owners of real property that is wholly exempt from property taxation under the Constitution and laws of North Carolina, railroad companies, public utilities as defined in G.S. 62-3(23), and electric or telephone membership corporations need not sign the petition. (G.S. 160A-58.1(a)).

OWNERS/PETITIONERS:

Individual(s):

Signature

Gregory A. Lapp
Print Name

1229 Maple Chase Lane
Address

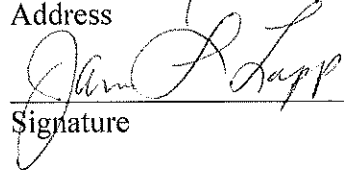
Signature

Jamie L. Lapp
Print Name

1229 Maple Chase Lane
Address

Corporate Entity:

Signature

Print Name

Company/Corporation Name

Title

Address

Date

Respectfully submitted this 7TH day of APRIL, 2023.

ORIGINAL w/ LOT 587

NORTH CAROLINA)

PETITION FOR VOLUNTARY ANNEXATION OF CONTIGUOUS PROPERTY TO THE CITY OF WINSTON-SALEM

FORSYTH COUNTY)

TO THE CITY COUNCIL OF THE CITY OF WINSTON-SALEM, NORTH CAROLINA:

1. We the undersigned owners of real property respectfully request that the area described below be annexed to the City of Winston-Salem.

2. Title of development or area BROOKBERRY FARM - PHASE 8

3. Name/address/phone number of petitioner NEVIN HOME BUILDERS, INC.
1223 MAPLE CHASE LANE W-S, NC 27106
487 BROOKBERRY FARM CIR. W-S, NC 27106
439 BROOKBERRY FARM CIR. WS NC 27106

4. Number of acres 439 Tax Block (s) 6576 Tax Lot (s) 587 & 613

5. Developer's projection of number/type of units to be developed by end of: 595
Year 1 _____ Year 2 _____
Year 3 _____ Build out _____

6. Developer's estimated value at the end of:
Year 1 _____ Year 2 _____ Year 3 _____ Build out _____

7. Map Attached: Forsyth County Tax Map _____ OR Official Survey Map

8. The area to be annexed is contiguous to the City of Winston-Salem, and the boundaries of such territory are as follows:

Respectfully submitted this 9TH day of NOVEMBER, 2022.

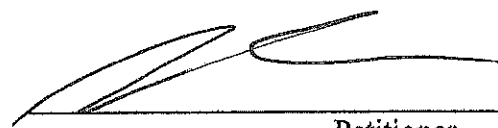

Petitioner

(If additional space is needed, please attach a separate sheet. Return form with attachments to the City Clerk, Suite 140, City Hall, Telephone: (336) 727-2224.)

NORTH CAROLINA)
FORSYTH COUNTY)

PETITION FOR VOLUNTARY ANNEXATION
OF CONTIGUOUS PROPERTY TO THE CITY
OF WINSTON-SALEM

TO THE CITY COUNCIL OF THE CITY OF WINSTON-SALEM, NORTH CAROLINA:

1. We the undersigned owners of real property respectfully request that the area described below be annexed to the City of Winston-Salem.
2. Title of development or area BROOKBERRY FARM, PHASE B
3. Name/address/phone number of petitioner Robert Duggins : Jessica Duggins
1217 MAPLE CHASE LANE
WI-S, NC 27106
4. Number of acres .40 Tax Block (s) 6576 Tax Lot (s) 014
5. Developer's projection of number/type of units to be developed by end of:
Year 1 _____ Year 2 _____
Year 3 _____ Build out _____
6. Developer's estimated value at the end of:
Year 1 _____ Year 2 _____ Year 3 _____ Build out _____
7. Map Attached: Forsyth County Tax Map _____ OR Official Survey Map
8. The area to be annexed is contiguous to the City of Winston-Salem, and the boundaries of such territory are as follows:

Respectfully submitted this 18TH day of JANUARY, 20 23.



Petitioner

(If additional space is needed, please attach a separate sheet. Return form with attachments to the City Clerk, Suite 140, City Hall, Telephone: (336) 727-2224.)

NORTH CAROLINA)
FORSYTH COUNTY)

PETITION FOR VOLUNTARY ANNEXATION
OF CONTIGUOUS PROPERTY TO THE CITY
OF WINSTON-SALEM

TO THE CITY COUNCIL OF THE CITY OF WINSTON-SALEM, NORTH CAROLINA:

1. We the undersigned owners of real property respectfully request that the area described below be annexed to the City of Winston-Salem.
2. Title of development or area BROOKBERRY FARM - PHASE 8
3. Name/address/phone number of petitioner AHER BUILDERS
1211 MAPLE CHASE LANE
W-3, NC 27106
4. Number of acres .40 Tax Block (s) 0576 Tax Lot (s) 615
5. Developer's projection of number/type of units to be developed by end of:
Year 1 _____ Year 2 _____
Year 3 _____ Build out _____
6. Developer's estimated value at the end of:
Year 1 _____ Year 2 _____ Year 3 _____ Build out _____
7. Map Attached: Forsyth County Tax Map _____ OR Official Survey Map
8. The area to be annexed is contiguous to the City of Winston-Salem, and the boundaries of such territory are as follows:

Respectfully submitted this 25TH ~~JANUARY~~ day of JANUARY, 20 23.

Sanjay Aher
Petitioner

(If additional space is needed, please attach a separate sheet. Return form with attachments to the City Clerk, Suite 140, City Hall, Telephone: (336) 727-2224.)

Survey Description:

Lying and being in the City of Winston-Salem, Winston-Salem Township, Forsyth County, North Carolina, and more particularly described as follows:

Commencing at a P-K Nail Found having NC Grid NAD83(2011) coordinates of Northing 859,674.97 feet, Easting 1,594,600.75 feet, also being a P-K Nail Found west of the intersection of Brookberry Farm Circle and Walnut Park Lane as recorded in Plat Book 53, Page 109 in the Forsyth County Register of Deeds; thence North 40°24'55" East 38.46 feet to an 1 Inch Iron Pipe Found being the True Point of Beginning; thence through the property of now or formerly Brookberry Farm, LLC as recorded in Deed Book 3559, Page 3235 and Deed Book 3164, Page 4189; thence the following sixty-three (63) courses:

- 1) along the arc of a curve to the right having a radius of 195.00 feet with a chord bearing and distance of South 60° 15' 19" West 121.25 feet to a point;
- 2) South 11° 37' 50" East 60.00 feet to a point;
- 3) along the arc of a curve to the left having a radius of 255.00 feet with a chord bearing and distance of North 70° 42' 44" East 67.96 feet to a point;
- 4) along the arc of a curve to the right having a radius of 13.50 feet with a chord bearing and distance of South 68° 41' 11" East 20.15 feet to a point;
- 5) South 63° 11' 24" West 192.62 feet to a 1 Inch Iron Pipe Found;
- 6) along the arc of a curve to the right having a radius of 255.00 feet with a chord bearing and distance of South 68° 08' 03" West 43.96 feet to a 1 Inch Iron Pipe Found;
- 7) North 17° 35' 43" West 20.00 feet to a 1 Inch Iron Pipe Found;
- 8) along the arc of a curve to the right having a radius of 235.00 feet with a chord bearing and distance of South 82° 01' 23" West 72.61 feet to a 1 Inch Iron Pipe Found;
- 9) South 08° 23' 50" West 176.84 feet to a 1 Inch Iron Pipe Found;
- 10) North 65° 19' 17" West 176.31 feet to a 1 Inch Iron Pipe Found;
- 11) North 63° 10' 15" West 50.17 feet to a 1 Inch Iron Pipe Found;
- 12) North 42° 38' 31" West 143.14 feet to a 1 Inch Iron Pipe Found;
- 13) North 87° 52' 44" West 115.04 feet to a 1 Inch Iron Pipe Found;

- 14) along the arc of a curve to the left having a radius of 382.46 feet with a chord bearing and distance of North 03° 52' 26" West 113.31 feet to a 1 Inch Iron Pipe Found;
- 15) along the arc of a curve to the right having a radius of 867.57 feet with a chord bearing and distance of North 07° 31' 53" West 147.05 feet to a 1 Inch Iron Pipe Found;
- 16) along the arc of a curve to the right having a radius of 377.03 feet with a chord bearing and distance of North 17° 41' 47" East 143.15 feet to a 1 Inch Iron Pipe Found;
- 17) along the arc of a curve to the left having a radius of 165.69 feet with a chord bearing and distance of North 15° 43' 50" West 167.21 feet to a 1 Inch Iron Pipe Found;
- 18) North 42° 51' 14" East 135.03 feet to a 1 Inch Iron Pipe Found;
- 19) along the arc of a curve to the left having a radius of 200.00 feet with a chord bearing and distance of North 75° 21' 10" West 114.73 feet to a 1 Inch Iron Pipe Found;
- 20) along the arc of a curve to the left having a radius of 930.76 feet with a chord bearing and distance of South 80° 52' 17" West 230.36 feet to a 1 Inch Iron Pipe Found;
- 21) along the arc of a curve to the left having a radius of 4,741.82 feet with a chord bearing and distance of South 72° 19' 31" West 237.97 feet to a 1 Inch Iron Pipe Found;
- 22) along the arc of a curve to the left having a radius of 125.00 feet with a chord bearing and distance of South 46° 27' 22" West 103.40 feet to a 1 Inch Iron Pipe Found;
- 23) South 22° 01' 29" West 54.48 feet to a 1 Inch Iron Pipe Found;
- 24) South 85° 40' 22" East 103.84 feet to a 1 Inch Iron Pipe Found;
- 25) South 53° 20' 00" East 48.48 feet to a 1 Inch Iron Pipe Found;
- 26) South 11° 39' 07" West 180.90 feet to a 1 Inch Iron Pipe Found;
- 27) South 72° 31' 36" West 57.52 feet to a 1 Inch Iron Pipe Found;
- 28) South 77° 15' 57" West 452.84 feet to a 1 Inch Iron Pipe Found;
- 29) along the arc of a curve to the right having a radius of 554.77 feet with a chord bearing and distance of North 75° 14' 19" West 106.61 feet to a 1 Inch Iron Pipe Found;
- 30) along the arc of a curve to the right having a radius of 1037.63 feet with a chord bearing and distance of North 64° 25' 00" West 191.99 feet to a 1 Inch Iron Pipe Found;
- 31) along the arc of a curve to the right having a radius of 835.00 feet with a chord bearing and distance of North 46° 54' 33" West 352.90 feet to a 1 Inch Iron Pipe Found;
- 32) along the arc of a curve to the right having a radius of 455.00 feet with a chord bearing and distance of South 36° 19' 30" West 6.13 feet to a point;

- 33) North $53^{\circ} 17' 22''$ West 50.00 feet to a 1 Inch Iron Pipe Found;
- 34) North $88^{\circ} 42' 38''$ West 40.16 feet to a 1 Inch Iron Pipe Found;
- 35) along the arc of a curve to the right having a radius of 1,167.92 feet with a chord bearing and distance of North $83^{\circ} 54' 36''$ West 195.48 feet to a 1 Inch Iron Pipe Found;
- 36) North $79^{\circ} 06' 33''$ West 205.62 feet to a 1 Inch Iron Pipe Found;
- 37) along the arc of a curve to the left having a radius of 5,835.13 feet with a chord bearing and distance of South $02^{\circ} 35' 45''$ West 16.11 feet to a point;
- 38) North $87^{\circ} 29' 00''$ West 50.00 feet to a 1 Inch Iron Pipe Found;
- 39) North $90^{\circ} 00' 00''$ West 178.39 feet to a 1 Inch Iron Pipe Found;
- 40) North $01^{\circ} 38' 04''$ East 148.75 feet to a 1 Inch Iron Pipe Found;
- 41) North $06^{\circ} 13' 43''$ East 33.37 feet to a 1 Inch Iron Pipe Found;
- 42) along the arc of a curve to the left having a radius of 445.16 feet with a chord bearing and distance of North $81^{\circ} 58' 23''$ West 92.28 feet to a 1 Inch Iron Pipe Found;
- 43) North $87^{\circ} 45' 33''$ West 9.98 feet to a 1 Inch Iron Pipe Found;
- 44) North $01^{\circ} 59' 26''$ East 50.00 feet to a 1 Inch Iron Pipe Found;
- 45) South $87^{\circ} 48' 52''$ East 12.68 feet to a 1 Inch Iron Pipe Found;
- 46) along the arc of a curve to the left having a radius of 366.00 feet with a chord bearing and distance of North $87^{\circ} 09' 30''$ East 61.58 feet to a 1 Inch Iron Pipe Found;
- 47) along the arc of a curve to the right having a radius of 376.15 feet with a chord bearing and distance of North $84^{\circ} 51' 11''$ East 33.08 feet to a 1 Inch Iron Pipe Found;
- 48) North $06^{\circ} 13' 43''$ East 141.98 feet to a 1 Inch Iron Pipe Found;
- 49) along the arc of a curve to the right having a radius of 4,328.93 feet with a chord bearing and distance of South $84^{\circ} 29' 26''$ East 97.97 feet to a 1 Inch Iron Pipe Found;
- 50) South $83^{\circ} 25' 29''$ East 82.04 feet to a 1 Inch Iron Pipe Found;
- 51) South $83^{\circ} 46' 17''$ East 50.00 feet to a point;
- 52) South $06^{\circ} 13' 43''$ West 0.98 feet to a 1 Inch Iron Pipe Found;
- 53) along the arc of a curve to the right having a radius of 4,839.39 feet with a chord bearing and distance of South $81^{\circ} 50' 35''$ East 85.13 feet to a 1 Inch Iron Pipe Found;
- 54) along the arc of a curve to the right having a radius of 3,064.04 feet with a chord bearing and distance of South $81^{\circ} 05' 06''$ East 42.92 feet to a 1 Inch Iron Pipe Found;

- 55) along the arc of a curve to the right having a radius of 5,098.13 feet with a chord bearing and distance of South 81° 13' 07" East 47.13 feet to a 1 Inch Iron Pipe Found;
- 56) along the arc of a curve to the left having a radius of 3,180.57 feet with a chord bearing and distance of South 82° 20' 46" East 90.01 feet to a 1 Inch Iron Pipe Found;
- 57) along the arc of a curve to the left having a radius of 3,249.23 feet with a chord bearing and distance of South 83° 48' 21" East 87.50 feet to a 1 Inch Iron Pipe Found;
- 58) along the arc of a curve to the left having a radius of 1,286.12 feet with a chord bearing and distance of North 03° 55' 21" West 263.84 feet to a 1 Inch Iron Pipe Found;
- 59) North 71° 34' 40" East 147.58 feet to a 1 Inch Iron Pipe Found;
- 60) along the arc of a curve to the left having a radius of 306.21 feet with a chord bearing and distance of North 19° 46' 12" West 10.00 feet to a 1 Inch Iron Pipe Found;
- 61) North 71° 09' 57" East 50.02 feet to a 1 Inch Iron Pipe Found;
- 62) along the arc of a curve to the right having a radius of 356.21 feet with a chord bearing and distance of South 16° 58' 38" East 43.07 feet to a 1 Inch Iron Pipe Found;
- 63) North 73° 24' 32" East 156.98 feet to a 1/2 Inch Iron Pipe Found at the northwestern corner of now or formerly Heribert von Feilitzsch and wife, Berkley von Feilitzsch as recorded in Deed Book 3506, Page 1725; Deed Book 3333, Page 138 and Plat Book 71, Page 44; thence along the western, southern and eastern property lines of said Plat Book 71, Page 44, the following fourteen (14) courses:
- 1) South 01° 43' 59" East 366.00 feet to a 1 Inch Iron Pipe Found;
 - 2) South 42° 27' 30" West 143.91 feet to a 1/2 Inch Iron Pipe Found;
 - 3) South 40° 01' 43" East 122.77 feet to a 1/2 Inch Iron Pipe Found;
 - 4) South 56° 37' 05" East 125.04 feet to a 1/2 Inch Iron Pipe Found;
 - 5) South 63° 23' 26" East 205.75 feet to a 1/2 Inch Iron Pipe Found;
 - 6) South 72° 01' 18" East 83.85 feet to a 1/2 Inch Iron Pipe Found;
 - 7) along the arc of a curve to the left having a radius of 175.00 feet with a chord bearing and distance of South 89° 31' 16" East 117.53 feet to a 1/2 Inch Iron Pipe Found;
 - 8) North 58° 03' 36" East 94.63 feet to a 1/2 Inch Iron Pipe Found;
 - 9) North 47° 39' 05" East 51.67 feet to a 1/2 Inch Iron Pipe Found;
 - 10) North 28° 31' 21" East 72.32 feet to a 1/2 Inch Iron Pipe Found;
 - 11) North 13° 51' 19" East 80.83 feet to a 1/2 Inch Iron Pipe Found;

12) North 10° 30' 15" East 127.89 feet to a 1/2 Inch Iron Pipe Found;
13) North 22° 07' 15" East 63.75 feet to a 1/2 Inch Iron Pipe Found;
14) North 68° 14' 37" East 208.39 feet to a 1/2 Inch Iron Pipe Found at a eastern property line of said Brookberry Farm, LLC as recorded in Deed Book 3164, Page 4189; thence through the properties of said Brookberry Farm, LLC as recorded in Deed Book 3559, Page 3235 and Deed Book 3164, Page 4189 and now or formerly Brookberry Farm Residential Owners Master Association as recorded in Deed Book 2868, Page 2587 and Plat Book 55, Page 63, the following seventeen (17) courses:

- 1) North 68° 14' 37" East 76.03 feet to a 1 Inch Iron Pipe Found;
- 2) South 56° 19' 13" East 105.48 feet to a 1 Inch Iron Pipe Found;
- 3) South 81° 32' 35" East 65.46 feet to a 1 Inch Iron Pipe Found;
- 4) North 88° 46' 09" East 58.28 feet to a 1 Inch Iron Pipe Found;
- 5) South 31° 23' 08" East 7.58 feet to a 1 Inch Iron Pipe Found;
- 6) South 10° 18' 46" West 50.78 feet to a 1 Inch Iron Pipe Found;
- 7) South 34° 43' 34" East 133.14 feet to a 1 Inch Iron Pipe Found;
- 8) along the arc of a curve to the right having a radius of 250.00 feet with a chord bearing and distance of South 71° 19' 23" East 176.71 feet to a 1 Inch Iron Pipe Found;
- 9) along the arc of a curve to the right having a radius of 285.15 feet with a chord bearing and distance of South 20° 55' 16" East 283.09 feet to a 1 Inch Iron Pipe Found;
- 10) along the arc of a curve to the left having a radius of 395.00 feet with a chord bearing and distance of South 09° 02' 00" East 242.46 feet to a 1 Inch Iron Pipe Found;
- 11) along the arc of a curve to the right having a radius of 605.00 feet with a chord bearing and distance of South 24° 46' 42" East 44.93 feet to a 1 Inch Iron Pipe Found;
- 12) along the arc of a curve to the left having a radius of 185.00 feet with a chord bearing and distance of South 62° 07' 04" East 235.19 feet to a 1 Inch Iron Pipe Found;
- 13) North 11° 35' 07" West 20.00 feet to a 1 Inch Iron Pipe Found;
- 14) along the arc of a curve to the left having a radius of 165.00 feet with a chord bearing and distance of North 70° 48' 09" East 43.72 feet to a 1 Inch Iron Pipe Found;
- 15) North 63° 11' 24" East 179.21 feet to a 1 Inch Iron Pipe Found;
- 16) along the arc of a curve to the left having a radius of 180.00 feet with a chord bearing and distance of North 52° 30' 12" East 65.51 feet to a 1 Inch Iron Pipe Found;

17) South 46° 23' 22" East 15.00 feet to the True Point of Beginning, containing 26.118 acres.

SURVEYOR CERTIFICATION:

I, KIM R. LILLY, CERTIFY THAT THIS PLAT WAS DRAWN UNDER MY SUPERVISION FROM AN ACTUAL SURVEY MADE UNDER MY SUPERVISION FROM DEED DESCRIPTION RECORDED IN DEED BOOK 3164, PAGE 4189 AND DEED BOOK 3559, PAGE 3235, DEED BOOK 2888, PAGE 2587 AND PLAT BOOK 55, PAGE 63 THAT THE BOUNDARIES NOT SURVEYED ARE CLEARLY INDICATED AS DRAWN FROM INFORMATION FOUND IN DEED BOOK 2888, PAGE 2587, DEED BOOK 3164, PAGE 4189, DEED BOOK 3333, PAGE 139, DEED BOOK 3526, PAGE 1725, DEED BOOK 3528, PAGE 471, DEED BOOK 3559, PAGE 3235, PLAT BOOK 53, PAGE 14, PLAT BOOK 53, PAGES 108 AND 109, PLAT BOOK 55, PAGE 63 AND PLAT BOOK 71, PAGE 45. THAT THE RATIO OF PRECISION AS CALCULATED IS 1:37,458 AND THAT THIS MAP MEETS THE REQUIREMENTS OF THE STANDARDS OF PRACTICE FOR LAND SURVEYING IN NORTH CAROLINA (23 NCAC 56.100). WITNESS MY ORIGINAL SIGNATURE, REGISTRATION NUMBER AND SEAL THIS 3RD DAY OF OCTOBER, 2023 A.D. AND REVISED THE 9TH DAY OF MARCH, 2023 A.D.

I, KIM R. LILLY, FURTHER CERTIFY THAT THIS MAP WAS DRAWN UNDER MY SUPERVISION FROM AN ACTUAL GPS SURVEY MADE UNDER MY SUPERVISION AND THE FOLLOWING INFORMATION WAS USED TO PERFORM THE SURVEY:

- 1) CLASS OF SURVEY: URBAN LAND SURVEY (CLASS A)
- 2) POSITIONAL ACCURACY: 0.05'
- 3) TYPE OF GPS FIELD PROCEDURE: GPS/VRS
- 4) DATES OF SURVEY: AUGUST 24, 2018
- 5) DATUM/EPOCH: NAD 83 (NSRS 2011)
- 6) PUBLISHED/FIXED-CONTROL USE: NONE
- 7) GEOID MODEL: GEOID 12B
- 8) COMBINED GRID FACTOR(S): 0.999951982
- 9) UNITS: US FEET

Kim R. Lilly
 SURVEYOR
 L-3612
 LICENSE NUMBER
 3-9-2023

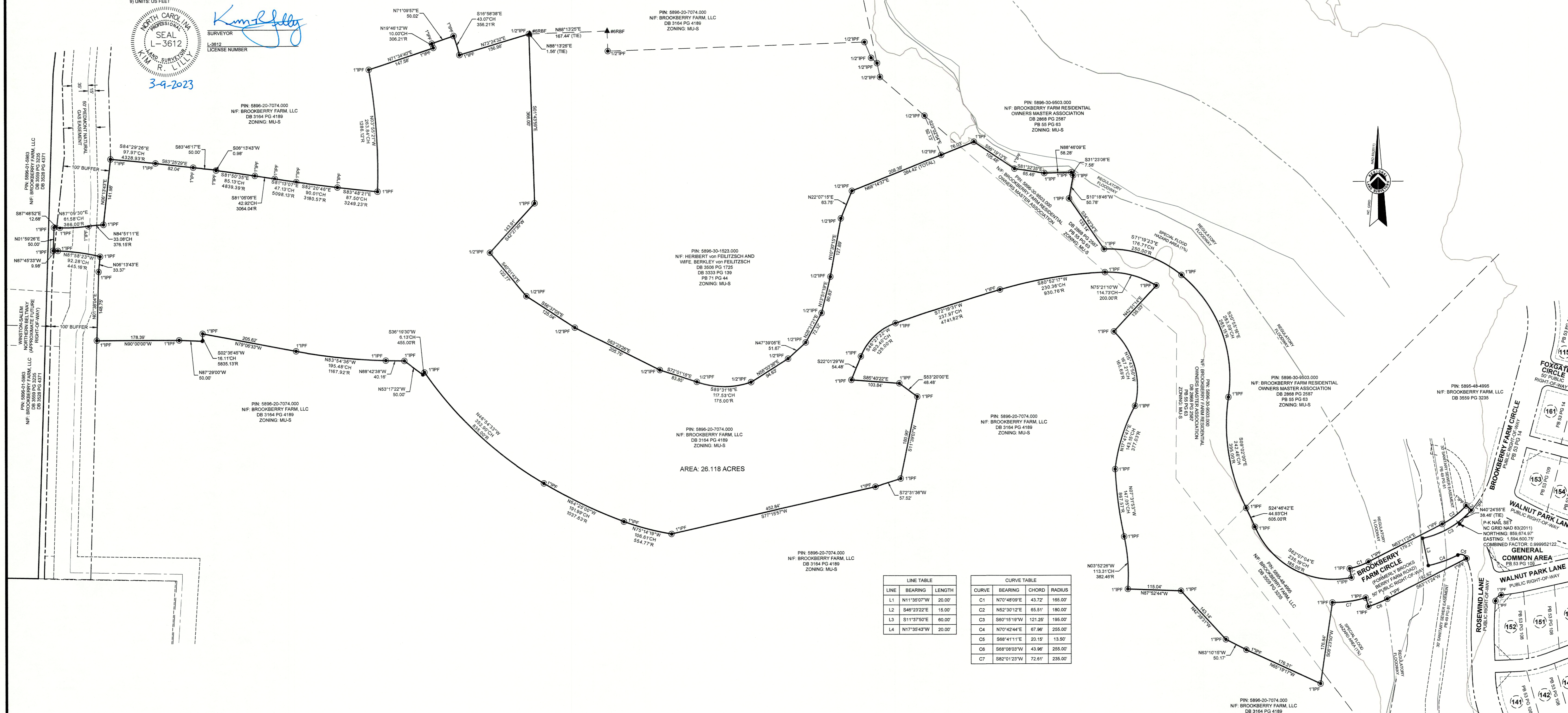
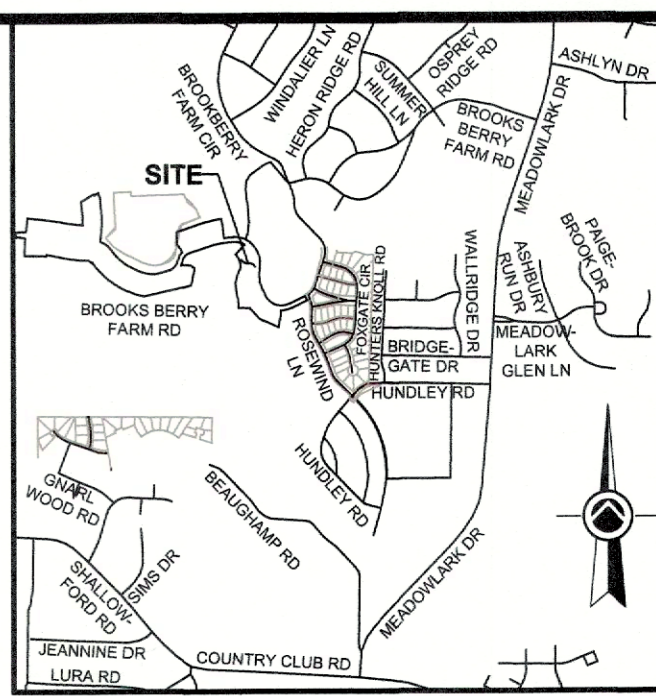

AREA: 26.118 ACRES

LINE TABLE

LINE	BEARING	LENGTH
L1	N70°48'09\"	20.00'
L2	S46°23'22\"	15.00'
L3	S11°37'50\"	60.00'
L4	N17°35'43\"	20.00'

CURVE TABLE

CURVE	BEARING	CHORD	RADIUS
C1	N70°48'09\"	43.72'	165.00'
C2	N52°30'12\"	65.61'	160.00'
C3	S60°15'19\"	121.25'	195.00'
C4	N70°42'44\"	67.96'	255.00'
C5	S88°41'11\"	20.15'	13.50'
C6	S88°08'03\"	43.96'	255.00'
C7	S82°01'23\"	72.61'	235.00'

- NOTES:**
1. SITE REFERENCE: BROOKBERRY FARM, LLC A PORTION OF PIN: 5896-20-7074.000, DEED BOOK 3164, PAGE 4189 AND A PORTION OF PIN: 5896-48-4995, DEED BOOK 3559, PAGE 3235, AND BROOKBERRY FARM RESIDENTIAL OWNERS MASTER ASSOCIATION, PIN: 5896-30-6503.000, DEED BOOK 2888, PAGE 2587 AND PLAT BOOK 55, PAGE 63 AS RECORDED IN THE FORSYTH COUNTY REGISTRY.
 2. AREA: 26.118 ACRES
 3. ALL DISTANCES ARE HORIZONTAL GROUND, UNLESS OTHERWISE NOTED.
 4. INFORMATION SHOWN HEREON IS FROM DIRECT FIELD DATA COLLECTED AUGUST 24 TO SEPTEMBER 21, 2018.
 5. A TITLE SEARCH WAS NOT PERFORMED FOR THIS SURVEY.
 6. SITE IS PARTIALLY LOCATED IN A KNOWN FLOOD PLAIN AS DETERMINED BY THE FEDERAL EMERGENCY MANAGEMENT AGENCY AS ILLUSTRATED BY THE FLOOD INSURANCE RATE MAP COMMUNITY PANEL NO. 3710589600J DATED JANUARY 2, 2009 AND PANEL NO. 3710589600J DATED JANUARY 2, 2009.
 7. NO NCGS MONUMENT WITHIN 2000' OF SITE.
 8. SUBJECT TO ANY AND ALL EASEMENTS, RIGHTS-OF-WAY, STREETS AND ASSESSMENTS AS THE SAME MAY APPEAR OF RECORD IN THE FORSYTH COUNTY REGISTER OF DEEDS.
 9. THIS PARCEL IS LOCATED WITHIN APPROVED MASTER PLAN LAND BAY III, REFERENCE REZONING CASE 1-1008.
 10. NORTH CAROLINA GRID COORDINATES AS SHOWN HEREON WERE DERIVED FROM DIRECT GPS OBSERVATIONS UTILIZING THE NORTH CAROLINA GEODETIC SURVEY'S NETWORK RTK SYSTEM AND ARE REFERENCED TO THE NAD(83)/NSRS(2011) DATUM GPS OBSERVATION PERFORMED ON AUGUST 24, 2018.

- LEGEND**
- COMPUTED POINT
 - IRON PIPE FOUND (SIZE AS NOTED)
 - ▲ PK-NAIL FOUND
 - ▲ REBAR FOUND (SIZE AS NOTED)
 - N/F NOW OR FORMERLY
 - DB DEED BOOK
 - PB PLAT BOOK
 - PG PAGE
- LINE LEGEND**
- SUBJECT BOUNDARY LINE (SURVEYED)
 - OLD BOUNDARY LINE
 - ADJOINER BOUNDARY LINE (NOT SURVEYED)
 - - - RIGHT-OF-WAY LINE
 - - - EASEMENT

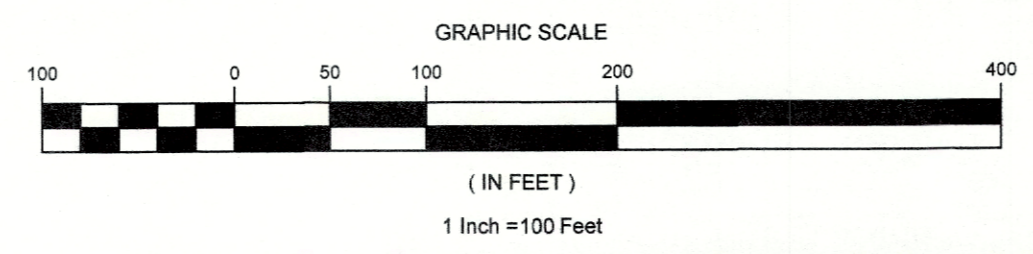

**BOUNDARY EXHIBIT
 BROOKBERRY FARM
 PHASE 8
 BROOKS BERRY FARM ROAD
 WINSTON-SALEM TOWNSHIP
 FORSYTH COUNTY
 WINSTON-SALEM, NORTH CAROLINA**

RLS
 SURVEYING & CONSULTING
 REGIONAL LAND SURVEYORS, INC.
 8542 WEST MARKET STREET, SUITE 100
 GREENSBORO, NORTH CAROLINA 27409
 NC FIRM LICENSE NO. C-1362

OWNERS:
 BROOKBERRY FARM, LLC
 3600 COUNTRY CLUB ROAD SUITE 200
 WINSTON-SALEM, NORTH CAROLINA 27104
 (336) 794-1780

DATE: 10-03-2023
 DRAWN BY: JAD
 CHECKED BY: JAD
 REV 1: REVISED RIGHT-OF-WAY AT BRIDGE (07-26-2023) JAD
 REV 2: ADDED LINE AND CURVE TABLES (03-08-2023) JAD