

W-3498 Area Plan Recommendations

Northwest Winston-Salem Area Plan Update, 2017
(Proposed land uses shown are generalized. See area plan for specific recommendations.)

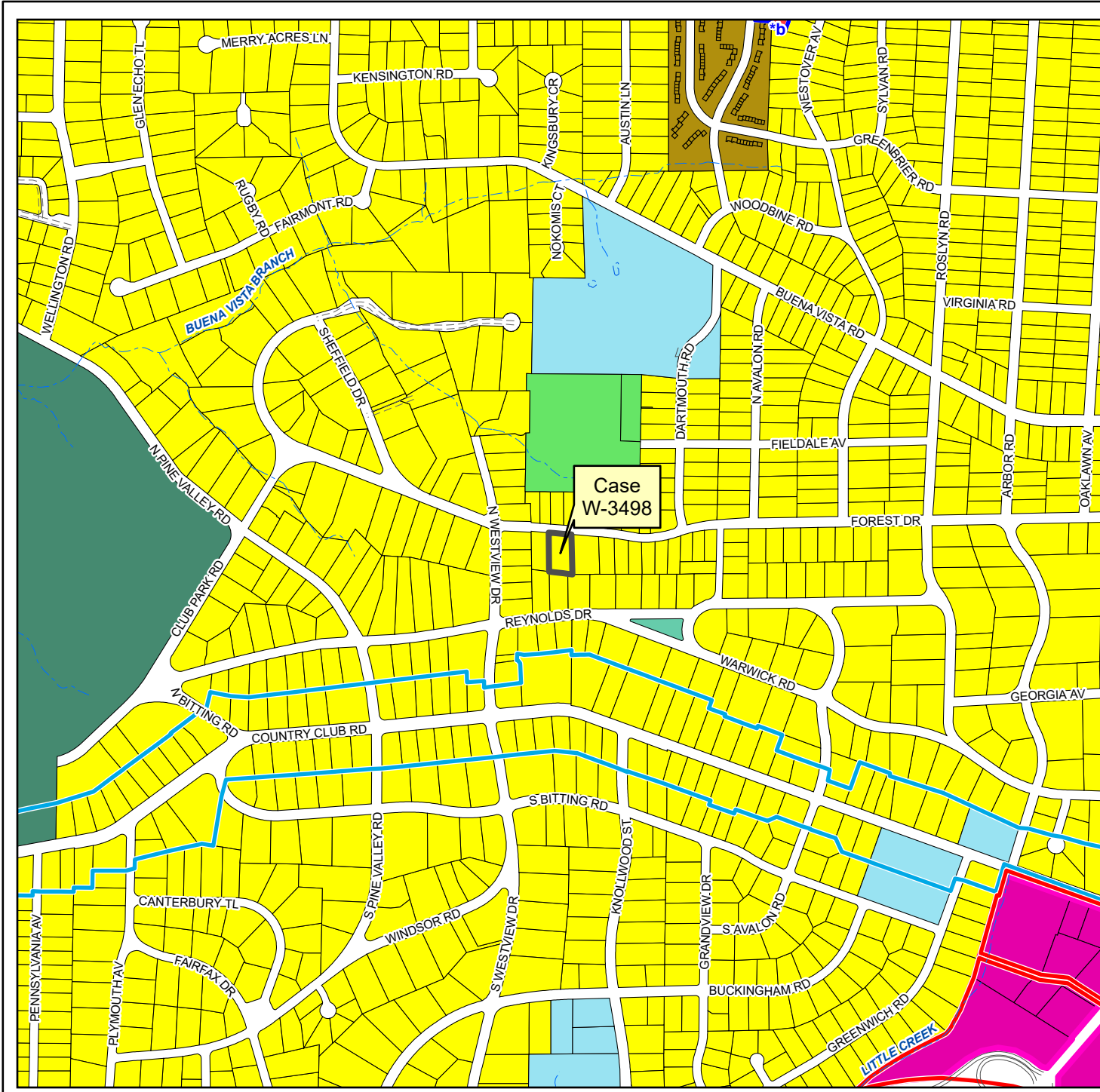

- Rezoning
- Activity Center
- Special Land Use Condition Areas
- Proposed Land Use**
 - Single-Family Residential (0-8 Du/Ac)
 - Intermediate-Density Residential (8.1-18 DU/Ac)
 - Commercial
 - Mixed-Use Development
 - Institutional
 - Park
 - Open space
 - Commercial Recreation
- Proposed Growth Corridor**
 - Urban/Suburban Form - Single-Family Residential
 - Urban Form - Commercial/Office/Multifamily
 - Mixed-Use Areas

